

平壓花姆指螺帽 · DIN 653

EH 24770.



產品描述

所有滾花螺絲是整體都有螺紋的一體成型製品 (DIN-代號 A)。

材質

- 鋼、染黑、品質 5.8
- 不銹鋼 1.4305, 鈍化噴砂

更多資訊

注意事項

根據 DIN 規範, 壓花的間距和深度也不同。

圖面

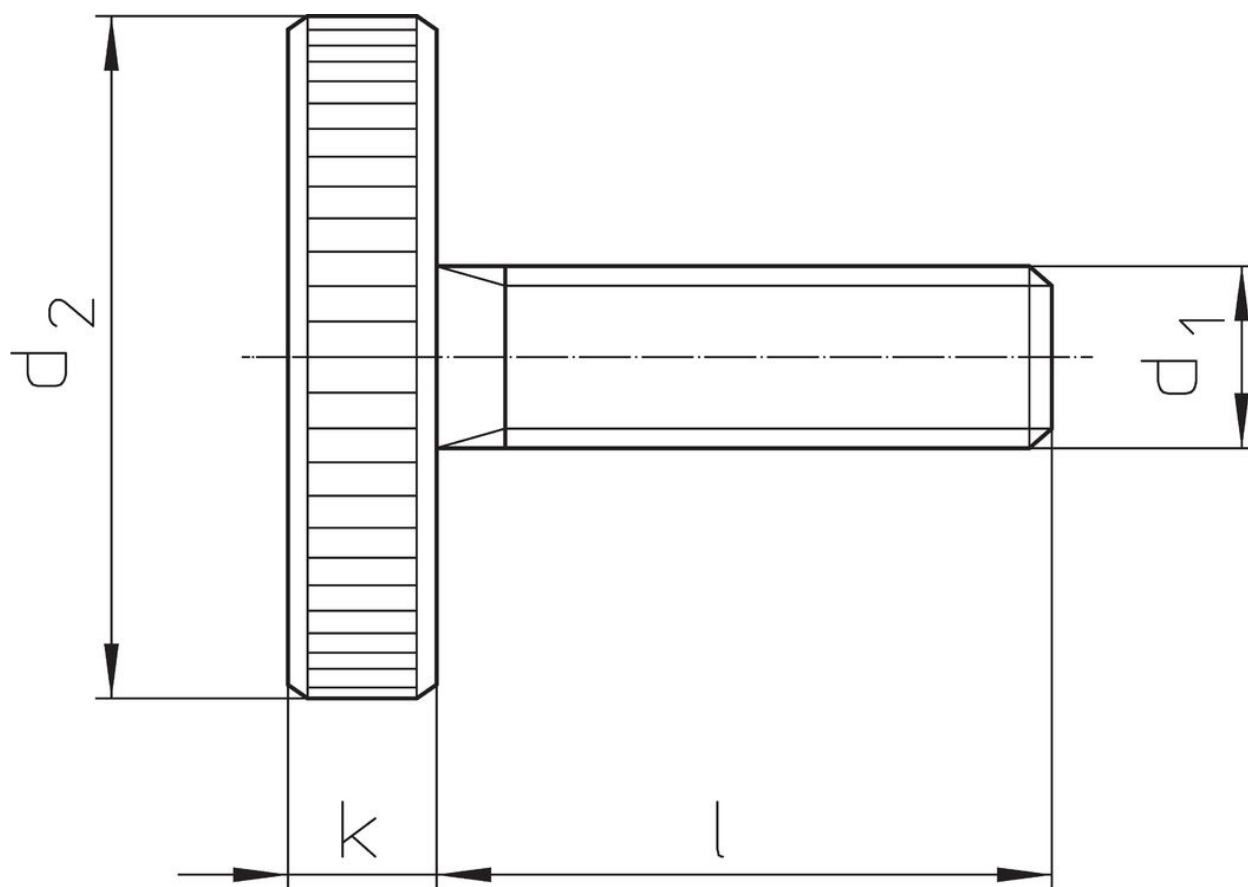

訂單資訊

d ₁	l	尺寸		d ₂	k	[g]	品號
		[mm]					
鋼							
M 3	6			12	2,5	2,3	24770.0072
M 3	8			12	2,5	2,4	24770.0073
M 3	10			12	2,5	2,5	24770.0074
M 3	16			12	2,5	2,7	24770.0077
M 3	20			12	2,5	2,9	24770.0079
M 4	8			16	3,5	5,6	24770.0092
M 4	10			16	3,5	5,7	24770.0093
M 4	12			16	3,5	6,1	24770.0094

d ₁	l	尺寸		k	[g]	品號
		[mm]				
M 4	16	16	3,5	6,2	24770.0096	
M 4	20	16	3,5	6,6	24770.0098	
M 4	25	16	3,5	7,1	24770.0100	
M 5	10	20	4,0	10,0	24770.0112	
M 5	12	20	4,0	11,0	24770.0113	
M 5	16	20	4,0	12,0	24770.0115	
M 5	20	20	4,0	12,0	24770.0117	
M 5	25	20	4,0	12,0	24770.0119	
M 5	30	20	4,0	13,0	24770.0121	
M 6	12	24	5,0	18,0	24770.0132	
M 6	16	24	5,0	20,0	24770.0134	
M 6	20	24	5,0	21,0	24770.0136	
M 6	25	24	5,0	21,0	24770.0138	
M 6	30	24	5,0	22,0	24770.0140	
M 6	40	24	5,0	23,0	24770.0142	
M 8	16	30	6,0	36,0	24770.0152	
M 8	20	30	6,0	37,0	24770.0154	
M 8	25	30	6,0	39,0	24770.0156	
M 8	30	30	6,0	40,0	24770.0158	
M 8	35	30	6,0	42,0	24770.0160	
M 8	40	30	6,0	44,0	24770.0161	
M10	20	36	8,0	71,0	24770.0172	
M10	25	36	8,0	72,0	24770.0174	
M10	30	36	8,0	76,0	24770.0176	
M10	35	36	8,0	78,0	24770.0178	
M10	40	36	8,0	80,0	24770.0180	
不銹鋼						
M 4	8	16	3,5	5,6	24770.0292	
M 4	10	16	3,5	5,7	24770.0293	
M 4	12	16	3,5	6,1	24770.0294	
M 4	16	16	3,5	6,2	24770.0296	
M 5	10	20	4,0	10,0	24770.0312	
M 5	12	20	4,0	11,0	24770.0313	
M 5	16	20	4,0	12,0	24770.0315	
M 5	20	20	4,0	12,0	24770.0317	
M 6	12	24	5,0	18,0	24770.0332	
M 6	16	24	5,0	20,0	24770.0334	
M 6	20	24	5,0	21,0	24770.0336	
M 6	25	24	5,0	21,0	24770.0338	
M 8	16	30	6,0	36,0	24770.0352	
M 8	20	30	6,0	37,0	24770.0354	
M 8	25	30	6,0	39,0	24770.0356	
M 8	30	30	6,0	40,0	24770.0358	
M10	20	36	8,0	71,0	24770.0372	
M10	25	36	8,0	72,0	24770.0374	
M10	30	36	8,0	76,0	24770.0376	
M10	40	36	8,0	80,0	24770.0380	

遵守

有關詳細的合規信息，請選擇所需的貨號。