

## 定位珠螺絲·有頭 EH 22710.



### 產品描述

球頭推力螺釘還可用於夾緊、擰緊或支撐非平行表面。  
平面的可移動球可實現平面負載傳輸。

### 材質

#### 珠子

- 軸承鋼，硬化
- 不鏽鋼，硬化

#### 螺絲

- 鋼，熱處理， $1200 \pm 100 \text{ N/mm}^2$
- 不鏽鋼 1.4305

### 更多資訊

#### 注意事項

珠子無防止旋轉功能。  
特殊的樣式歡迎洽詢。

#### 參考

螺紋鎖附依需求，請參閱附錄 - 技術數據 -

#### 更多產品

- 定位珠螺絲, 有頭, 球防止迴轉

### 圖面

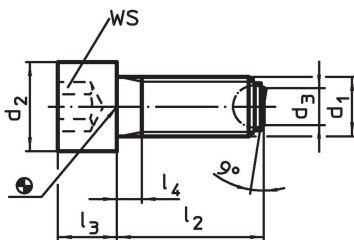

### 訂單資訊

d <sub>1</sub>	l <sub>2</sub> ~	d <sub>2</sub>	尺寸			球直徑	WS [mm]	靜態荷 重能力 <sup>1)</sup> max. [kN]	[g]	品號
			d <sub>3</sub> [mm]	l <sub>3</sub>	l <sub>4</sub>					
<b>軸承面平整, 熱處理鋼</b>										
M 6	20	10	3,2	6	3,0	4,0	5	9	6,1	<a href="#">22710.0562</a>
M 6	30	10	3,2	6	3,0	4,0	5	9	7,8	<a href="#">22710.0564</a>
M 6	40	10	3,2	6	16,0	4,0	5	9	9,9	<a href="#">22710.0566</a>
M 8	20	13	4,5	8	3,5	5,5	6	15	12,0	<a href="#">22710.0582</a>
M 8	35	13	4,5	8	3,5	5,5	6	15	17,0	<a href="#">22710.0584</a>
M 8	50	13	4,5	8	22,0	5,5	6	15	23,0	<a href="#">22710.0586</a>
M10	25	16	6,0	10	4,5	7,0	8	20	24,0	<a href="#">22710.0602</a>
M10	40	16	6,0	10	4,5	7,0	8	20	32,0	<a href="#">22710.0604</a>
M10	60	16	6,0	10	28,0	7,0	8	20	44,0	<a href="#">22710.0606</a>
M12	30	18	7,2	12	5,0	8,5	10	30	38,0	<a href="#">22710.0622</a>
M12	50	18	7,2	12	5,0	8,5	10	30	52,0	<a href="#">22710.0624</a>
M12	80	18	7,2	12	44,0	8,5	10	30	80,0	<a href="#">22710.0626</a>
M16	40	24	10,7	16	6,0	12,0	14	60	95,0	<a href="#">22710.0662</a>
M16	60	24	10,7	16	6,0	12,0	14	60	121,0	<a href="#">22710.0664</a>
M16	80	24	10,7	16	36,0	12,0	14	60	153,0	<a href="#">22710.0666</a>
M20	50	30	13,5	20	7,5	15,0	17	90	185,0	<a href="#">22710.0702</a>
M20	80	30	13,5	20	28,0	15,0	17	90	254,0	<a href="#">22710.0704</a>
M20	100	30	13,5	20	48,0	15,0	17	90	304,0	<a href="#">22710.0706</a>
M24	60	36	15,8	24	9,0	18,0	19	120	323,0	<a href="#">22710.0742</a>
M24	90	36	15,8	24	30,0	18,0	19	120	424,0	<a href="#">22710.0744</a>
M24	120	36	15,8	24	60,0	18,0	19	120	526,0	<a href="#">22710.0746</a>
<b>軸承面平整, 不銹鋼</b>										
M 6	20	10	3,2	6	3,0	4,0	5	9	6,1	<a href="#">22710.0832</a>
M 6	30	10	3,2	6	3,0	4,0	5	9	7,8	<a href="#">22710.0834</a>
M 6	40	10	3,2	6	16,0	4,0	5	9	9,9	<a href="#">22710.0836</a>
M 8	20	13	4,5	8	3,5	5,5	6	15	12,0	<a href="#">22710.0842</a>

<sup>1)</sup>\*荷重能力報告書不適用於不銹鋼

d <sub>1</sub>	l <sub>2</sub> ~	d <sub>2</sub>	尺寸			球直徑	WS [mm]	靜態荷 重能力 <sup>1)</sup> max. [kN]	🔩 [g]	品號
			d <sub>3</sub>	l <sub>3</sub>	l <sub>4</sub>					
M 8	35	13	4,5	8	3,5	5,5	6	15	17,0	22710.0844
M 8	50	13	4,5	8	22,0	5,5	6	15	23,0	22710.0846
M10	25	16	6,0	10	4,5	7,0	8	20	24,0	22710.0852
M10	40	16	6,0	10	4,5	7,0	8	20	32,0	22710.0854
M10	60	16	6,0	10	28,0	7,0	8	20	44,0	22710.0856
M12	30	18	7,2	12	5,0	8,5	10	30	38,0	22710.0862
M12	50	18	7,2	12	5,0	8,5	10	30	52,0	22710.0864
M12	80	18	7,2	12	44,0	8,5	10	30	80,0	22710.0866
M16	40	24	10,7	16	6,0	12,0	14	60	95,0	22710.0872
M16	60	24	10,7	16	6,0	12,0	14	60	121,0	22710.0874
M16	80	24	10,7	16	36,0	12,0	14	60	153,0	22710.0876
軸承面帶肋, 熱處理鋼										
M 8	20	13	4,5	8	3,5	5,5	6	15	12,0	22710.0892
M 8	35	13	4,5	8	3,5	5,5	6	15	17,0	22710.0894
M 8	50	13	4,5	8	22,0	5,5	6	15	23,0	22710.0896
M10	25	16	6,0	10	4,5	7,0	8	20	24,0	22710.0902
M10	40	16	6,0	10	4,5	7,0	8	20	31,0	22710.0904
M10	60	16	6,0	10	28,0	7,0	8	20	44,0	22710.0906
M12	30	18	7,2	12	5,0	8,5	10	30	38,0	22710.0922
M12	50	18	7,2	12	5,0	8,5	10	30	52,0	22710.0924
M12	80	18	7,2	12	44,0	8,5	10	30	80,0	22710.0926
M16	40	24	10,7	16	6,0	12,0	14	60	93,0	22710.0962
M16	60	24	10,7	16	6,0	12,0	14	60	121,0	22710.0964
M16	80	24	10,7	16	36,0	12,0	14	60	152,0	22710.0966
M20	50	30	13,5	20	7,5	15,0	17	90	184,0	22710.0972
M20	80	30	13,5	20	28,0	15,0	17	90	255,0	22710.0974
M20	100	30	13,5	20	48,0	15,0	17	90	303,0	22710.0976
M24	60	36	15,8	24	9,0	18,0	19	120	324,0	22710.0982
M24	90	36	15,8	24	30,0	18,0	19	120	426,0	22710.0984
M24	120	36	15,8	24	60,0	18,0	19	120	528,0	22710.0986

<sup>1)</sup> \*荷重能力報告書不適用於不銹鋼

## 遵守

### 符合 RoHS

符合指令 2011/65/EU 和指令 2015/863

### 不含 SVHC 物質

不含超過 0.1% w/w 的 SVHC 物質 - 截至 2024 年 6 月 27 日的 SVHC 清單。

### 不含 65 號提案物質

不包括 65 號提案物質

<https://www.P65Warnings.ca.gov/>

### 不含衝突礦物

本產品不含來自剛果民主共和國或鄰近國家的任何被指定為“衝突礦物”的物質，例如鈿、錫、金或鎢。