

Stjärnvred • DIN 6335 lättmetall EH 24630.

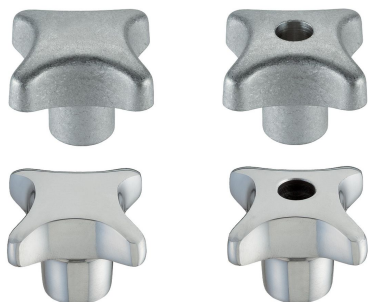

Produktbeskrivning

These palm grips are manufactured according to DIN 6335.

Material

Handtag

- Lättmetall AL, opolerat
- Lättmetall AL, polerat

Ritning



Bild 1



Bild 2

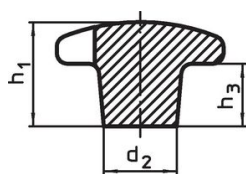

Bild 3

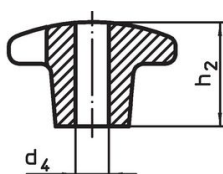

Bild 4

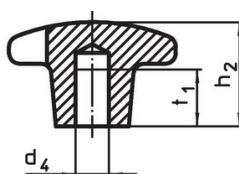

Bild 5

Orderinformation

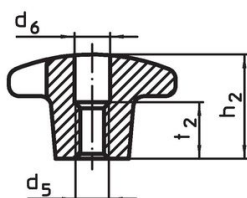
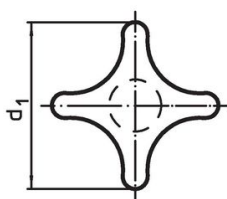
d ₁	d ₂	d ₄ H7	d ₅	Dimension						[g]	Art.nr.	
				d ₆	h ₁	h ₂	h ₃	t ₁	t ₂			
[mm]												
Obehandlat, form A – Bild 1, opolerat												
40	14	–	–	–	26	–	14	–	–	–	27	24630.0040
50	18	–	–	–	34	–	20	–	–	–	51	24630.0050
63	20	–	–	–	42	–	25	–	–	–	95	24630.0063
80	25	–	–	–	52	–	30	–	–	–	161	24630.0080
Med bottenhål form C – Bild 3, opolerat												
40	14	8	–	–	–	25	–	15	–	–	23	24630.0240
50	18	10	–	–	–	32	–	18	–	–	42	24630.0250
63	20	12	–	–	–	40	–	22	–	–	73	24630.0263
80	25	16	–	–	–	50	–	28	–	–	138	24630.0280
Med invändig gänga, genomgående hål, form D – Bild 4, opolerat												
40	14	–	M 8	8,4	–	25	–	–	–	13	23	24630.0340
50	18	–	M10	10,5	–	32	–	–	–	16	44	24630.0350
63	20	–	M12	13,0	–	40	–	–	–	20	70	24630.0363
80	25	–	M16	17,0	–	50	–	–	–	20	129	24630.0380
Med bottenhål med invändig gänga, form E – Bild 5, opolerat												
40	14	–	M 8	–	–	25	–	15	–	–	24	24630.0440
50	18	–	M10	–	–	32	–	18	–	–	46	24630.0450
63	20	–	M12	–	–	40	–	22	–	–	74	24630.0463
80	25	–	M16	–	–	50	–	28	–	–	142	24630.0480

d ₁	d ₂	d ₄ H7	d ₅	Dimension						[g]	Art.nr.
				d ₆	h ₁	h ₂	h ₃	t ₁	t ₂		
[mm]											
Med bottenhål form C – Bild 3, polerat											
40	14	8	–	–	–	25	–	15	–	23	24630.0640
50	18	10	–	–	–	32	–	18	–	42	24630.0650
63	20	12	–	–	–	40	–	22	–	73	24630.0663
80	25	16	–	–	–	50	–	28	–	138	24630.0680
Med invändig gänga, genomgående hål, form D – Bild 4, polerat											
40	14	–	M 8	8,4	–	25	–	–	13	23	24630.0740
50	18	–	M10	10,5	–	32	–	–	16	44	24630.0750
63	20	–	M12	13,0	–	40	–	–	20	70	24630.0763
80	25	–	M16	17,0	–	50	–	–	20	129	24630.0780
Med bottenhål med invändig gänga, form E – Bild 5, polerat											
40	14	–	M 8	–	–	25	–	15	–	24	24630.0840
50	18	–	M10	–	–	32	–	18	–	46	24630.0850
63	20	–	M12	–	–	40	–	22	–	74	24630.0863
80	25	–	M16	–	–	50	–	28	–	142	24630.0880

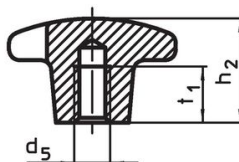
Användningsexempel

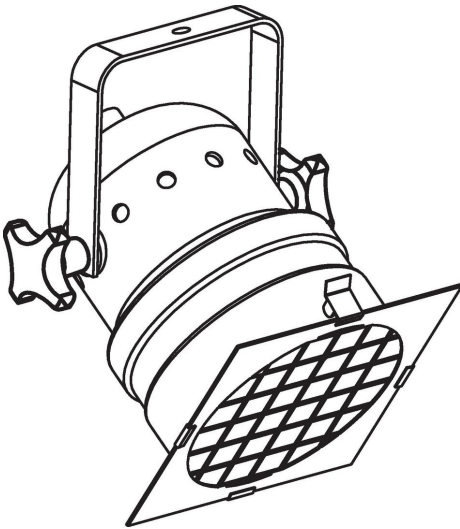

Överensstämmelse

For detailed compliance information please select the desired article number.