

Stoppskruv • med dyna i plast

EH 22760.



Produktbeskrivning

Stoppskruvarna användes till exempel för skonsammare stopp eller tryck på gängor, axlar och ytbehandlade arbetsstycken.

Material

Dyna

- Thermoplast vit (POM)

Skruv

- Stål, svartoxiderat
- Rostfritt stål 1.4305

Mer information

Ytterligare produkter

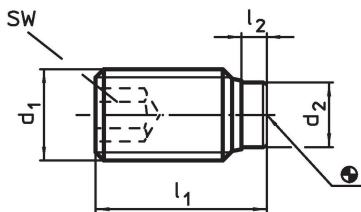

- Stoppskruv, Med mässingstapp

Ritning



Orderinformation

| d ₁ | Dimension | | | SW | | | | Art.nr. |
|-----------------------|----------------|----------------|----------------|------|------|------|------|----------------------------|
| | l ₁ | l ₂ | d ₂ | | min. | max. | | |
| | [mm] | | | [mm] | [°C] | | [g] | |
| Rostfritt stål | | | | | | | | |
| M 3 | 3,8 | 0,8 | 1,5 | 1,5 | -30 | 80 | 0,1 | 22760.0632 |
| M 3 | 5,8 | 0,8 | 1,5 | 1,5 | -30 | 80 | 0,3 | 22760.0634 |
| M 3 | 8,8 | 0,8 | 1,5 | 1,5 | -30 | 80 | 0,4 | 22760.0636 |
| M 3 | 10,8 | 0,8 | 1,5 | 1,5 | -30 | 80 | 0,4 | 22760.0638 |
| M 4 | 7,0 | 1,0 | 2,0 | 1,5 | -30 | 80 | 0,3 | 22760.0642 |
| M 4 | 9,0 | 1,0 | 2,0 | 2,0 | -30 | 80 | 0,5 | 22760.0643 |
| M 4 | 11,0 | 1,0 | 2,0 | 2,0 | -30 | 80 | 0,7 | 22760.0644 |
| M 4 | 13,0 | 1,0 | 2,0 | 2,0 | -30 | 80 | 0,7 | 22760.0645 |
| M 4 | 17,0 | 1,0 | 2,0 | 2,0 | -30 | 80 | 1,1 | 22760.0646 |
| M 5 | 9,0 | 1,0 | 3,0 | 2,5 | -30 | 80 | 0,7 | 22760.0652 |
| M 5 | 11,0 | 1,0 | 3,0 | 2,5 | -30 | 80 | 0,9 | 22760.0653 |
| M 5 | 13,0 | 1,0 | 3,0 | 2,5 | -30 | 80 | 1,2 | 22760.0654 |
| M 5 | 17,0 | 1,0 | 3,0 | 2,5 | -30 | 80 | 1,6 | 22760.0655 |
| M 5 | 21,0 | 1,0 | 3,0 | 2,5 | -30 | 80 | 2,2 | 22760.0656 |
| M 6 | 11,3 | 1,3 | 3,5 | 3,0 | -30 | 80 | 1,3 | 22760.0662 |
| M 6 | 13,3 | 1,3 | 3,5 | 3,0 | -30 | 80 | 1,7 | 22760.0663 |
| M 6 | 17,3 | 1,3 | 3,5 | 3,0 | -30 | 80 | 2,2 | 22760.0664 |
| M 6 | 21,3 | 1,3 | 3,5 | 3,0 | -30 | 80 | 3,0 | 22760.0665 |
| M 6 | 26,3 | 1,3 | 3,5 | 3,0 | -30 | 80 | 3,8 | 22760.0666 |
| M 6 | 33,3 | 1,3 | 3,5 | 3,0 | -30 | 80 | 5,1 | 22760.0667 |
| M 8 | 13,6 | 1,6 | 5,0 | 4,0 | -30 | 80 | 2,5 | 22760.0682 |
| M 8 | 17,6 | 1,6 | 5,0 | 4,0 | -30 | 80 | 3,7 | 22760.0683 |
| M 8 | 21,6 | 1,6 | 5,0 | 4,0 | -30 | 80 | 5,0 | 22760.0684 |
| M 8 | 26,6 | 1,6 | 5,0 | 4,0 | -30 | 80 | 6,5 | 22760.0685 |
| M 8 | 33,6 | 1,6 | 5,0 | 4,0 | -30 | 80 | 8,8 | 22760.0686 |
| M 8 | 41,6 | 1,6 | 5,0 | 4,0 | -30 | 80 | 11,0 | 22760.0687 |
| M10 | 17,9 | 1,9 | 6,5 | 5,0 | -30 | 80 | 5,4 | 22760.0702 |

| d ₁ | Dimension | | | SW |  | |  | Art.nr. |
|----------------|-----------------------------|---------------------|----------------|-----|---|------|---|----------------------------|
| | l ₁ ~ [mm] | l ₂ ~ | d ₂ | | min. | max. | | |
| M10 | 21,9 | 1,9 | 6,5 | 5,0 | -30 | 80 | 7,2 | 22760.0703 |
| M10 | 26,9 | 1,9 | 6,5 | 5,0 | -30 | 80 | 9,9 | 22760.0704 |
| M10 | 33,9 | 1,9 | 6,5 | 5,0 | -30 | 80 | 13,0 | 22760.0705 |
| M10 | 41,9 | 1,9 | 6,5 | 5,0 | -30 | 80 | 17,0 | 22760.0706 |
| M10 | 51,9 | 1,9 | 6,5 | 5,0 | -30 | 80 | 22,0 | 22760.0707 |
| M12 | 22,1 | 2,1 | 8,0 | 6,0 | -30 | 80 | 9,1 | 22760.0722 |
| M12 | 27,1 | 2,1 | 8,0 | 6,0 | -30 | 80 | 13,0 | 22760.0723 |
| M12 | 34,1 | 2,1 | 8,0 | 6,0 | -30 | 80 | 18,0 | 22760.0724 |
| M12 | 42,1 | 2,1 | 8,0 | 6,0 | -30 | 80 | 23,0 | 22760.0725 |
| M12 | 52,1 | 2,1 | 8,0 | 6,0 | -30 | 80 | 30,0 | 22760.0726 |
| M12 | 65,1 | 2,1 | 8,0 | 6,0 | -30 | 80 | 40,0 | 22760.0727 |
| Stål | | | | | | | | |
| M 4 | 7,0 | 1,0 | 2,0 | 1,5 | -30 | 80 | 0,3 | 22760.0242 |
| M 4 | 9,0 | 1,0 | 2,0 | 1,5 | -30 | 80 | 0,4 | 22760.0243 |
| M 4 | 11,0 | 1,0 | 2,0 | 1,5 | -30 | 80 | 0,6 | 22760.0244 |
| M 4 | 13,0 | 1,0 | 2,0 | 1,5 | -30 | 80 | 0,7 | 22760.0245 |
| M 4 | 17,0 | 1,0 | 2,0 | 1,5 | -30 | 80 | 1,0 | 22760.0246 |
| M 4 | 21,0 | 1,0 | 2,0 | 1,5 | -30 | 80 | 1,3 | 22760.0247 |
| M 5 | 9,0 | 1,0 | 3,0 | 2,5 | -30 | 80 | 0,7 | 22760.0252 |
| M 5 | 11,0 | 1,0 | 3,0 | 2,5 | -30 | 80 | 0,9 | 22760.0253 |
| M 5 | 13,0 | 1,0 | 3,0 | 2,5 | -30 | 80 | 1,2 | 22760.0254 |
| M 5 | 17,0 | 1,0 | 3,0 | 2,5 | -30 | 80 | 1,6 | 22760.0255 |
| M 5 | 21,0 | 1,0 | 3,0 | 2,5 | -30 | 80 | 2,2 | 22760.0256 |
| M 5 | 26,0 | 1,0 | 3,0 | 2,5 | -30 | 80 | 2,6 | 22760.0257 |
| M 6 | 11,3 | 1,3 | 3,5 | 3,0 | -30 | 80 | 1,3 | 22760.0262 |
| M 6 | 13,3 | 1,3 | 3,5 | 3,0 | -30 | 80 | 1,7 | 22760.0263 |
| M 6 | 17,3 | 1,3 | 3,5 | 3,0 | -30 | 80 | 2,2 | 22760.0264 |
| M 6 | 21,3 | 1,3 | 3,5 | 3,0 | -30 | 80 | 3,0 | 22760.0265 |
| M 6 | 26,3 | 1,3 | 3,5 | 3,0 | -30 | 80 | 3,8 | 22760.0266 |
| M 6 | 33,3 | 1,3 | 3,5 | 3,0 | -30 | 80 | 5,1 | 22760.0267 |
| M 6 | 41,3 | 1,3 | 3,5 | 3,0 | -30 | 80 | 6,3 | 22760.0268 |
| M 6 | 51,3 | 1,3 | 3,5 | 3,0 | -30 | 80 | 7,9 | 22760.0270 |
| M 8 | 13,6 | 1,6 | 5,0 | 4,0 | -30 | 80 | 2,5 | 22760.0282 |
| M 8 | 17,6 | 1,6 | 5,0 | 4,0 | -30 | 80 | 3,7 | 22760.0283 |
| M 8 | 21,6 | 1,6 | 5,0 | 4,0 | -30 | 80 | 5,0 | 22760.0284 |
| M 8 | 26,6 | 1,6 | 5,0 | 4,0 | -30 | 80 | 6,5 | 22760.0285 |
| M 8 | 33,6 | 1,6 | 5,0 | 4,0 | -30 | 80 | 8,8 | 22760.0286 |
| M 8 | 41,6 | 1,6 | 5,0 | 4,0 | -30 | 80 | 11,0 | 22760.0287 |
| M 8 | 51,6 | 1,6 | 5,0 | 4,0 | -30 | 80 | 14,0 | 22760.0288 |
| M 8 | 64,6 | 1,6 | 5,0 | 4,0 | -30 | 80 | 18,0 | 22760.0290 |
| M10 | 17,9 | 1,9 | 6,5 | 5,0 | -30 | 80 | 5,4 | 22760.0302 |
| M10 | 21,9 | 1,9 | 6,5 | 5,0 | -30 | 80 | 7,2 | 22760.0303 |
| M10 | 26,9 | 1,9 | 6,5 | 5,0 | -30 | 80 | 9,9 | 22760.0304 |
| M10 | 33,9 | 1,9 | 6,5 | 5,0 | -30 | 80 | 13,0 | 22760.0305 |
| M10 | 41,9 | 1,9 | 6,5 | 5,0 | -30 | 80 | 17,0 | 22760.0306 |
| M10 | 51,9 | 1,9 | 6,5 | 5,0 | -30 | 80 | 22,0 | 22760.0307 |
| M10 | 64,9 | 1,9 | 6,5 | 5,0 | -30 | 80 | 28,0 | 22760.0308 |
| M10 | 81,9 | 1,9 | 6,5 | 5,0 | -30 | 80 | 36,0 | 22760.0310 |
| M12 | 22,1 | 2,1 | 8,0 | 6,0 | -30 | 80 | 9,1 | 22760.0322 |
| M12 | 27,1 | 2,1 | 8,0 | 6,0 | -30 | 80 | 13,0 | 22760.0323 |
| M12 | 34,1 | 2,1 | 8,0 | 6,0 | -30 | 80 | 18,0 | 22760.0324 |
| M12 | 42,1 | 2,1 | 8,0 | 6,0 | -30 | 80 | 23,0 | 22760.0325 |
| M12 | 52,1 | 2,1 | 8,0 | 6,0 | -30 | 80 | 30,0 | 22760.0326 |
| M12 | 65,1 | 2,1 | 8,0 | 6,0 | -30 | 80 | 40,0 | 22760.0327 |
| M12 | 82,1 | 2,1 | 8,0 | 6,0 | -30 | 80 | 53,0 | 22760.0330 |
| M12 | 102,1 | 2,1 | 8,0 | 6,0 | -30 | 80 | 66,0 | 22760.0332 |

Överensstämmelse

För detaljerad överensstämmelseinformation, välj önskat artikelnummer.