

볼 노브 · 금속형 DIN 319와 유사  
EH 24561.



제품 설명

재질

- 스틸, 광택 처리, 밝은색
- 스테인리스 스틸 1.4305, 블라스트 가공처리
- 알루미늄, 유광

더 많은 정보

참조

금속 버전, DIN 319 C형

그림

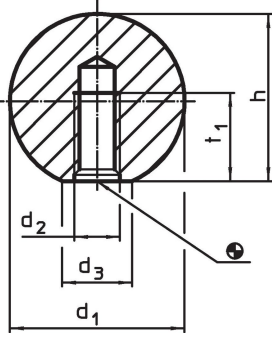

주문 정보

d <sub>1</sub>	d <sub>2</sub>	d <sub>3</sub> ~ [mm]	치수 h ~	t <sub>1</sub> 최소	 [g]	제품 번호.
<b>스틸</b>						
16	M 4	8	15,0	7,0	16	<a href="#">24561.0016</a>
20	M 5	12	18,0	9,0	26	<a href="#">24561.0020</a>
25	M 6	15	22,5	11,0	58	<a href="#">24561.0025</a>
32	M 8	18	29,0	14,5	116	<a href="#">24561.0032</a>
40	M10	22	37,0	18,0	241	<a href="#">24561.0040</a>
50	M12	27	46,0	21,0	475	<a href="#">24561.0050</a>
<b>스테인리스 스틸</b>						
16	M 4	8	15,0	7,0	16	<a href="#">24561.0216</a>
20	M 5	12	18,0	9,0	26	<a href="#">24561.0220</a>
25	M 6	15	22,5	11,0	58	<a href="#">24561.0225</a>
32	M 8	18	29,0	14,5	116	<a href="#">24561.0232</a>
40	M10	22	37,0	18,0	241	<a href="#">24561.0240</a>
<b>알루미늄 Al</b>						
16	M 4	8	15,0	7,0	16	<a href="#">24561.0116</a>
20	M 5	12	18,0	9,0	26	<a href="#">24561.0120</a>
25	M 6	15	22,5	11,0	58	<a href="#">24561.0125</a>
32	M 8	18	29,0	14,5	116	<a href="#">24561.0132</a>
40	M10	22	37,0	18,0	241	<a href="#">24561.0140</a>
50	M12	27	46,0	21,0	475	<a href="#">24561.0150</a>

적용 예

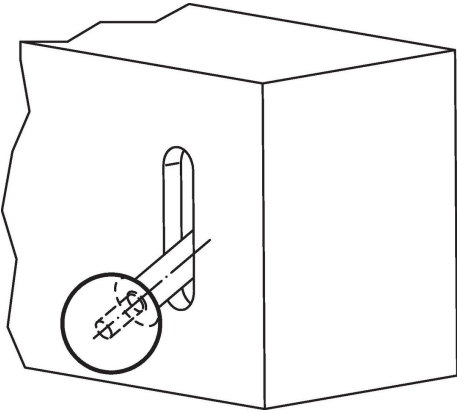

규정 준수

자세한 규정 준수 정보를 보려면 원하는 품목 번호를 선택하십시오.