

フラット・ナールド・ボルト・DIN 653 EH 24770.



製品説明

削り出しの一体物です。ネジ外径は首下まで加工してあります (DINのタイプA)。

材質

- スティール、黒染、強度クラス 5.8
- ステンレス鋼 1.4305 (SUS303相当)、サンドブラスト

更なる情報

備考

ナールド部のピッチと深さは、DIN規格と異なります。

寸法図

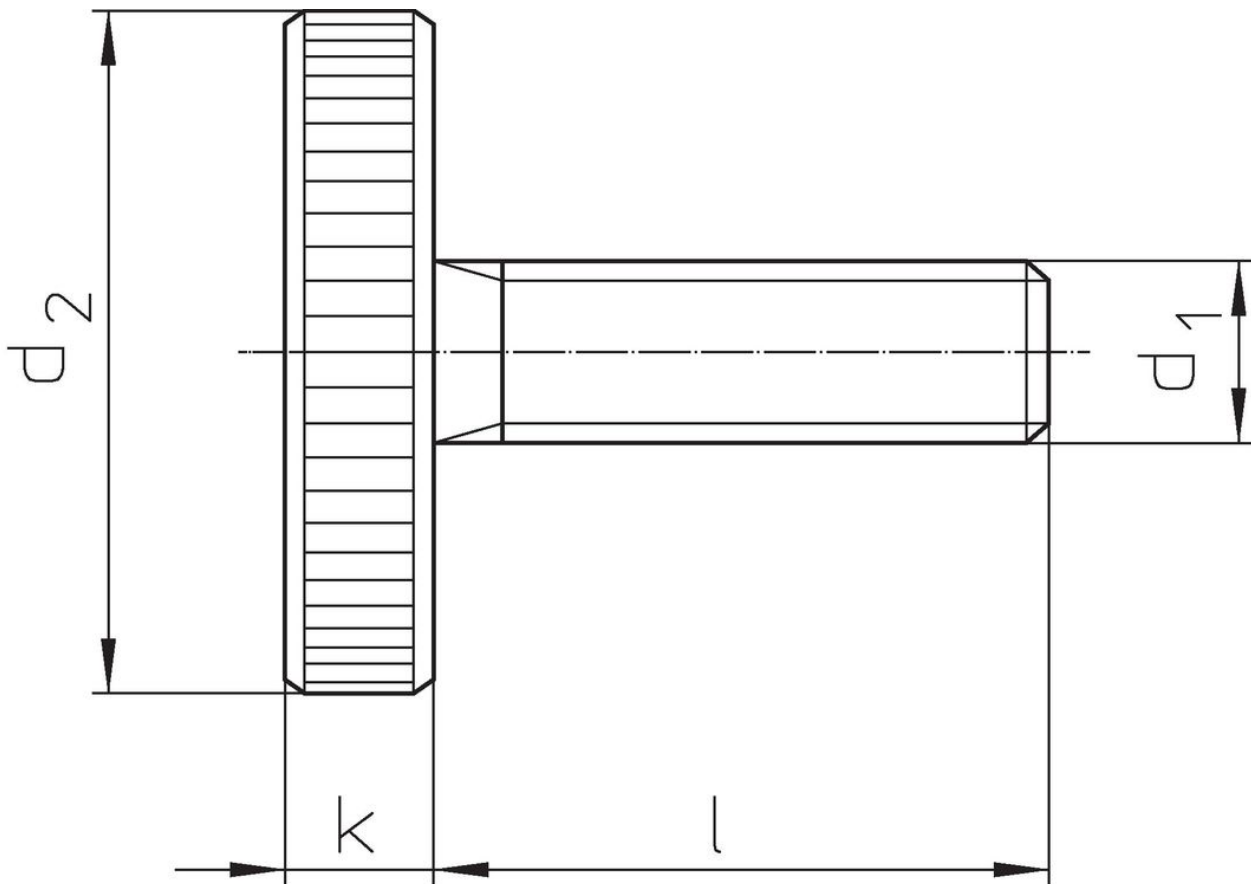

発注情報

| d ₁ | l | 寸法 | | d ₂ | k | 🔩 [g] | 製品番号 |
|----------------|----|------|--|----------------|-----|----------|------------|
| | | [mm] | | | | | |
| 鋼 | | | | | | | |
| M 3 | 6 | | | 12 | 2,5 | 2,3 | 24770.0072 |
| M 3 | 8 | | | 12 | 2,5 | 2,4 | 24770.0073 |
| M 3 | 10 | | | 12 | 2,5 | 2,5 | 24770.0074 |
| M 3 | 16 | | | 12 | 2,5 | 2,7 | 24770.0077 |
| M 3 | 20 | | | 12 | 2,5 | 2,9 | 24770.0079 |
| M 4 | 8 | | | 16 | 3,5 | 5,6 | 24770.0092 |
| M 4 | 10 | | | 16 | 3,5 | 5,7 | 24770.0093 |
| M 4 | 12 | | | 16 | 3,5 | 6,1 | 24770.0094 |

| d ₁ | 寸法 | | | k | 重量 [g] | 製品番号 |
|----------------|----|----------------|------|-----|-----------|------------|
| | l | d ₂ | [mm] | | | |
| M 4 | 16 | 16 | | 3,5 | 6,2 | 24770.0096 |
| M 4 | 20 | 16 | | 3,5 | 6,6 | 24770.0098 |
| M 4 | 25 | 16 | | 3,5 | 7,1 | 24770.0100 |
| M 5 | 10 | 20 | | 4,0 | 10,0 | 24770.0112 |
| M 5 | 12 | 20 | | 4,0 | 11,0 | 24770.0113 |
| M 5 | 16 | 20 | | 4,0 | 12,0 | 24770.0115 |
| M 5 | 20 | 20 | | 4,0 | 12,0 | 24770.0117 |
| M 5 | 25 | 20 | | 4,0 | 12,0 | 24770.0119 |
| M 5 | 30 | 20 | | 4,0 | 13,0 | 24770.0121 |
| M 6 | 12 | 24 | | 5,0 | 18,0 | 24770.0132 |
| M 6 | 16 | 24 | | 5,0 | 20,0 | 24770.0134 |
| M 6 | 20 | 24 | | 5,0 | 21,0 | 24770.0136 |
| M 6 | 25 | 24 | | 5,0 | 21,0 | 24770.0138 |
| M 6 | 30 | 24 | | 5,0 | 22,0 | 24770.0140 |
| M 6 | 40 | 24 | | 5,0 | 23,0 | 24770.0142 |
| M 8 | 16 | 30 | | 6,0 | 36,0 | 24770.0152 |
| M 8 | 20 | 30 | | 6,0 | 37,0 | 24770.0154 |
| M 8 | 25 | 30 | | 6,0 | 39,0 | 24770.0156 |
| M 8 | 30 | 30 | | 6,0 | 40,0 | 24770.0158 |
| M 8 | 35 | 30 | | 6,0 | 42,0 | 24770.0160 |
| M 8 | 40 | 30 | | 6,0 | 44,0 | 24770.0161 |
| M10 | 20 | 36 | | 8,0 | 71,0 | 24770.0172 |
| M10 | 25 | 36 | | 8,0 | 72,0 | 24770.0174 |
| M10 | 30 | 36 | | 8,0 | 76,0 | 24770.0176 |
| M10 | 35 | 36 | | 8,0 | 78,0 | 24770.0178 |
| M10 | 40 | 36 | | 8,0 | 80,0 | 24770.0180 |
| ステンレス鋼 | | | | | | |
| M 4 | 8 | 16 | | 3,5 | 5,6 | 24770.0292 |
| M 4 | 10 | 16 | | 3,5 | 5,7 | 24770.0293 |
| M 4 | 12 | 16 | | 3,5 | 6,1 | 24770.0294 |
| M 4 | 16 | 16 | | 3,5 | 6,2 | 24770.0296 |
| M 5 | 10 | 20 | | 4,0 | 10,0 | 24770.0312 |
| M 5 | 12 | 20 | | 4,0 | 11,0 | 24770.0313 |
| M 5 | 16 | 20 | | 4,0 | 12,0 | 24770.0315 |
| M 5 | 20 | 20 | | 4,0 | 12,0 | 24770.0317 |
| M 6 | 12 | 24 | | 5,0 | 18,0 | 24770.0332 |
| M 6 | 16 | 24 | | 5,0 | 20,0 | 24770.0334 |
| M 6 | 20 | 24 | | 5,0 | 21,0 | 24770.0336 |
| M 6 | 25 | 24 | | 5,0 | 21,0 | 24770.0338 |
| M 8 | 16 | 30 | | 6,0 | 36,0 | 24770.0352 |
| M 8 | 20 | 30 | | 6,0 | 37,0 | 24770.0354 |
| M 8 | 25 | 30 | | 6,0 | 39,0 | 24770.0356 |
| M 8 | 30 | 30 | | 6,0 | 40,0 | 24770.0358 |
| M10 | 20 | 36 | | 8,0 | 71,0 | 24770.0372 |
| M10 | 25 | 36 | | 8,0 | 72,0 | 24770.0374 |
| M10 | 30 | 36 | | 8,0 | 76,0 | 24770.0376 |
| M10 | 40 | 36 | | 8,0 | 80,0 | 24770.0380 |

法令(コンプライアンス)

詳細の法令情報については、目的の製品番号を選択してください。