

Cerniere • elongated on one side

EH 25165.



Descrizione prodotto

The different versions cover many applications that require a low load.

These metal hinges are characterised by their simple design and the different versions:

- without bores
- with bores
- with bores for countersunk screws

The version without bores can be assembled by welding or by inserting a specific drilling pattern.

Materiale

Corpo

- Acciaio inox 1.4301
- Acciaio, zincato e passivato

Asse

- Acciaio inox 1.4301

Disegno

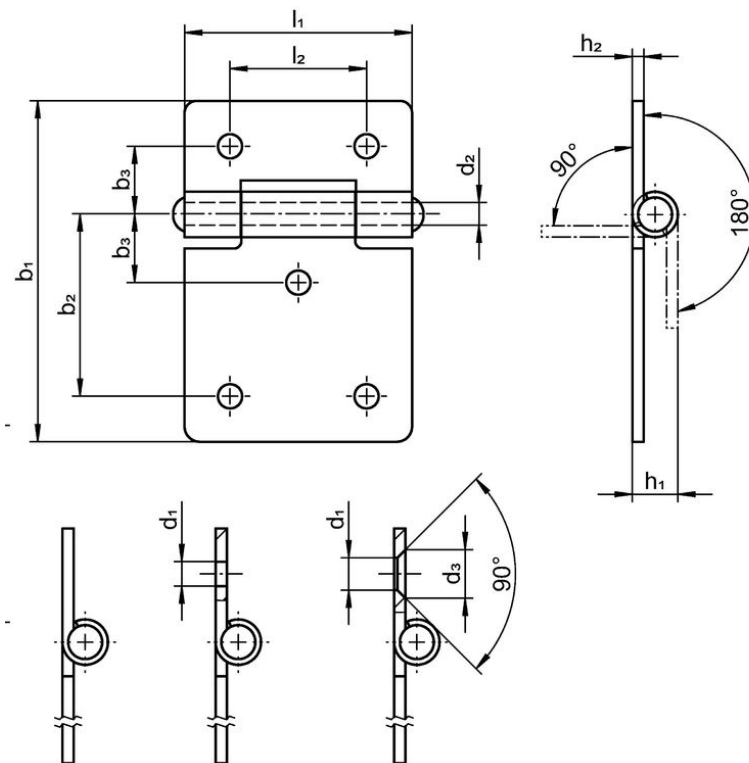

picture 1

picture 2

picture 3

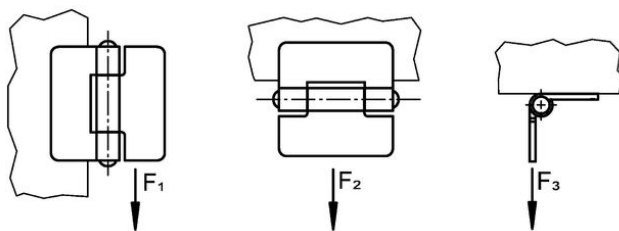

Caratteristiche

b ₁	l ₁	b ₂	b ₃	Dimensioni						Forza di ritegno				Codice
				d ₁	d ₂	d ₃	h ₁	h ₂	l ₂	F ₁	F ₂	F ₃		
[mm]										[N]			[g]	
without bores – Fig. 1, acciaio inox														
45	30	–	–	–	3	–	6	1,5	–	700	500	450	20	25165.0035
60	40	–	–	–	4	–	8	2,0	–	1200	1000	1000	47	25165.0055
75	50	–	–	–	6	–	10	2,0	–	1600	2000	1000	81	25165.0070
90	60	–	–	–	6	–	10	2,0	–	1100	2500	1000	111	25165.0080
with bores – Fig. 2, acciaio inox														
45	30	24,0	9,0	3,2	3	–	6	1,5	18	700	500	450	19	25165.0135
60	40	32,5	12,5	4,2	4	–	8	2,0	18	1200	1000	1000	45	25165.0155
75	50	40,0	15,0	5,2	6	–	10	2,0	30	1600	2000	1000	79	25165.0170
90	60	48,0	18,0	5,2	6	–	10	2,0	36	1100	2500	1000	108	25165.0180
with bores – Fig. 2, Acciaio														
45	30	24,0	9,0	3,2	3	–	6	1,5	18	700	500	450	19	25165.1035
60	40	32,5	12,5	4,2	4	–	8	2,0	25	1200	1000	1000	45	25165.1055
75	50	40,0	15,0	5,2	6	–	10	2,0	30	1600	2000	1000	79	25165.1070
90	60	48,0	18,0	5,2	6	–	10	2,0	36	1100	2500	1000	108	25165.1080
with bores for countersunk screws – Fig. 3, acciaio inox														
45	30	24,0	9,0	4,0	3	6,4	6	1,5	18	700	500	450	19	25165.0235
60	40	32,5	12,5	5,0	4	8,3	8	2,0	25	1200	1000	1000	45	25165.0255
75	50	40,0	15,0	5,0	6	8,3	10	2,0	30	1600	2000	1000	79	25165.0270
90	60	48,0	18,0	5,0	6	8,3	10	2,0	36	1100	2500	1000	108	25165.0280
with bores for countersunk screws – Fig. 3, Acciaio														
45	30	24,0	9,0	4,0	3	6,4	6	1,5	18	700	500	450	19	25165.2035
60	40	32,5	12,5	5,0	4	8,3	8	2,0	25	1200	1000	1000	45	25165.2055
75	50	40,0	15,0	5,0	6	8,3	10	2,0	30	1600	2000	1000	79	25165.2070
90	60	48,0	18,0	5,0	6	8,3	10	2,0	36	1100	2500	1000	108	25165.2080

Conformità

Conforme alla normativa RoHS

Conforme alla Direttiva 2011/65/UE e alla Direttiva 2015/863.

Non contiene sostanze SVHC

Nessuna sostanza SVHC con più dello 0,1% p/p contenuto - elenco SVHC [REACH] aggiornato al 23.01.2024.

Non contiene sostanze della Proposition 65

Nessuna sostanza contemplata nella Proposition 65
<https://www.P65Warnings.ca.gov/>

Privo di minerali di conflitto

Questo prodotto non contiene sostanze designate come "minerali da conflitto" come tantalio, stagno, oro o tungsteno della Repubblica Democratica del Congo o dei paesi limitrofi.