

简短操作指南

!DANGER!

注意：使用前，请阅读原始制造商的说明。这些可以从 www.halder.com/downloadcenter (1) 下载。

定位夹紧销专门用于两个组件或夹具系统的夹紧，紧固，调节，更改，固定和高精度定位。必须根据安全要求来使用定位夹紧销。脏物例如，沙砾和碎屑，油和乳胶沉积物，灰尘……) 可能会影响定位夹紧销的功能。

使用损坏的定位销可能会很危险。

在使用前，请仔细检查定位夹持销是否有明显的缺陷。(即变形，折断，撕裂，损坏，丢失的滚珠/ O形圈，腐蚀，解锁功能)。定位夹持销必须与 Erwin Halder KG 的定位衬套 (23111.) 配合使用，并且必须完全支撑在轴承表面上。插入定位夹持销时，必须防止负载旋转。

销损坏的定位夹持销必须立即退出维修。

处理和压力

为了使定位夹持销发挥其固定功能，可通过六角形套筒或可选地使用已安装的手动手柄进行锁定。要释放滚珠，请逆时针旋转六角形套筒或手动手柄，直到停止为止。

注意：当无法通过手动力进一步拧紧，则定位夹持销锁定。不要在负载下运行！

压力数值 (请参见第2页) 适用于定位衬套 (23111.) 中的固定。

维护：

必须停止使用定位夹持销，以使合格人员至少每年检查一次。

肉眼检查：

变形，折断，撕裂，球丢失/损坏/ O形圈，腐蚀。

性能检查：

球的锁定必须通过六角形或手动手柄来确保。



(1) Original operating instructions

Short Instruction Manual

!DANGER!

Attention: Read the original operating instructions before use.

These can be downloaded from www.halder.com/downloadcenter (1).

The positioning clamping pins are exclusively destined for clamping, fastening, adjusting, changing, securing and high-precision positioning of two components or fixture systems. Positioning clamping pins have to be used in accordance with safety requirements. Soilings (e.g. grits and grinds, oil and emulsion deposits, dust ...) can affect the functioning of positioning clamping pins.

Using damaged positioning clamping pins can be perilous.

Before any use carefully inspect the positioning clamping pins for visible defects (i.e. deformities, breaks, rips, damages, missing balls / o-ring, corrosion, unlocking function). Positioning clamping pins must be used with the locating bushings (23111.) from Erwin Halder KG and must bear completely on the bearing surface. When inserting a positioning clamping pin, the rotation of the load must be prevented.

Damaged positioning clamping pins must be withdrawn from service immediately.

Handling and Stress

To enable the positioning clamping pin to fulfil its holding function, locking is done via the hexagon socket or optionally with the mounted manual handle. To release the balls, turn the hexagon socket or optionally the manual handle counterclockwise out until it stops.

Attention: The positioning clamping pin is locked when it cannot be tightened any further by manual force. Do **not** operate under load!

The stress figures (see page 2) apply to the holding in a locating bushing (23111.).

Maintenance:

Positioning clamping pins must be taken out of service for proper inspection by a qualified person at least once a year.

Visual inspection:

Deformities, breaks, rips, missing / damaged balls / o-ring, corrosion

Performance check:

Locking of the balls must be ensured by the hexagon or the manual handle.



(1) Original operating instructions

FR: La traduction dans votre langue de cet manuel d'instruction succinct et de la déclaration de conformité est disponible sur www.halder.com

IT: La traduzione di questo breve manuale di istruzioni nella vostra lingua con la Dichiarazione di conformità è disponibile nel sito www.halder.com.

ES: La traducción de este breve manual de instrucciones en su idioma con la Declaración de conformidad está disponible en www.halder.com.

CZ: Překlad tohoto krátkého návodu ve vašem jazyce s prohlášením o shodě je k dispozici na www.halder.com.

RO: Acest scurt instructaj de utilizare, tradus în limba dumneavoastră, împreună cu Declarația de conformitate sunt disponibile pentru descărcare pe www.halder.com.

PL: Tłumaczenie tej krótkiej instrukcji obsługi na Twój język wraz z deklaracją zgodności jest dostępne na stronie www.halder.com.

FI: Tämän lyhyen käyttöohjeen käännös omalla kielelläsi ja vaatimustenmukaisuusvakuutus ovat saatavilla osoitteessa www.halder.com.

SE: En översättning av denna korta instruktionsmanual med försäkran om överensstämmelse finns på ditt spark att hämta på www.halder.com.

NL: De vertaling van deze korte handleiding in uw eigen taal met conformiteitsverklaring is beschikbaar op www.halder.com.

KR: 적합선 선언과 함께 귀하의 언어로 번역이 된 짧은 설명서는 www.halder.com에서 확인 가능합니다.

CN: 可在 www.halder.com 上获得带有符合性声明的此简短说明手册的翻译版本。

TW: 可在 www.halder.com 上获得带有符合性声明的此简短说明手册的翻译版本。

JP: CE準拠の宣言書は、取扱説明書に付属していますが、以下URLでダウンロードできます www.halder.com。

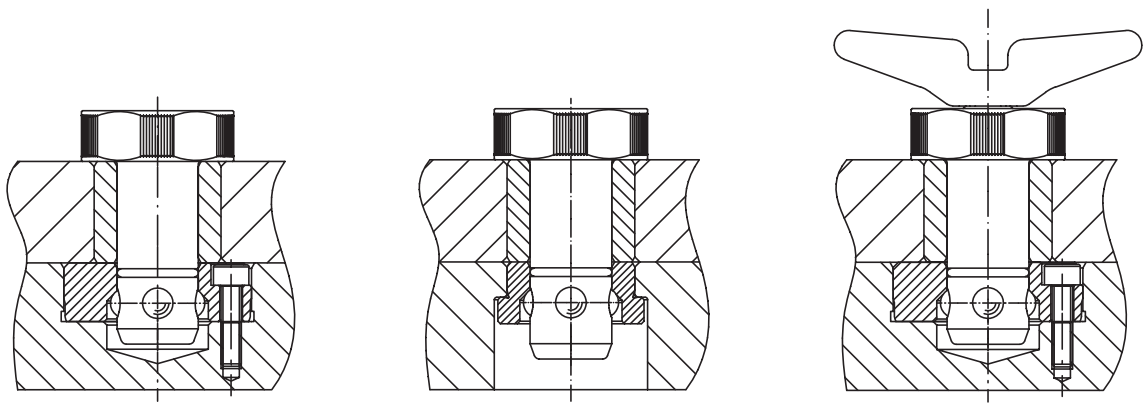

d ₁ -0,02 -0,05	l ₁ +0,6	尺寸 / Dimensions					l ₂ ±1	l ₃	s max.	用于基板 / for base plates ±0,05 [mm]	WS ₁ [mm]	WS ₂ [mm]	夹持力 / Holding force [kN]	🔩 [g]	品号 / Art. No.	
		d ₂	d ₃	d ₄	热处理钢 / Heat-treated steel	不锈钢 / Stainless- steel										
[mm]																
16	25	18,7	32	M4	13,6	10	9	20	30	6	5	105	23111.0016	23111.0116		
	30	18,7	32	M4	13,6	10	9	25	30	6	5	115	23111.0018	23111.0118		
20	25	23,6	40	M4	13,6	10	9	20	38	6	6	170	23111.0020	23111.0120		
	30	23,6	40	M4	13,6	10	9	25	38	6	6	185	23111.0022	23111.0122		
25	25	29,0	45	M4	18,6	10	9	20	43	10	8	255	23111.0025	23111.0125		
	30	29,0	45	M4	18,6	10	9	25	43	10	8	275	23111.0027	23111.0127		
30	25	34,6	55	M4	18,6	10	9	20	53	10	10	375	23111.0030	23111.0130		
	30	34,6	55	M4	18,6	10	9	25	53	10	10	400	23111.0032	23111.0132		

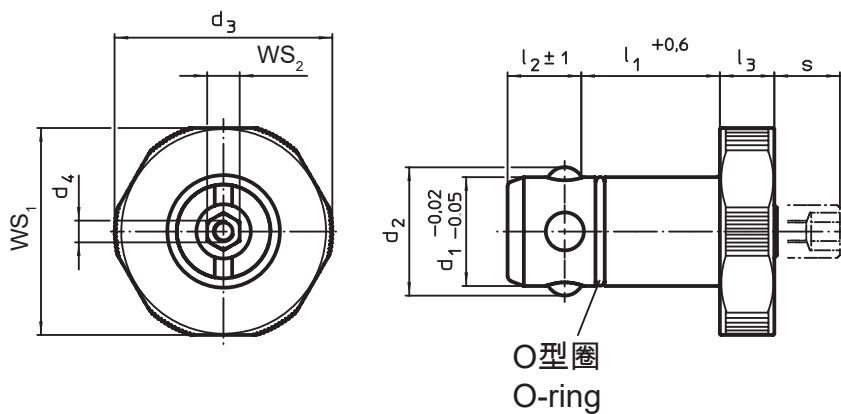

EC一致性声明 / EC Declaration of conformity

此产品符合 EC 指令 2006/42/EC.

This product is conform with the EC Directive 2006/42/EC.

制造商 / Manufacturer: *

地址 / Address: *

* 对文件负责 /
responsible for documentation

Erwin Halder KG
Erwin-Halder-Strasse 5 - 9
88480 Achstetten-Bronnen
Germany



产品 / Product:

类型 / Type:

定位夹持销 / Positioning Clamping Pin
EH 23111.

适用标准 /

Applied standards:

DIN EN 13155:2003+A2:2009 / EN ISO 12100:2010

Achstetten-Bronnen, 5. 2021年7月

S. Halder
Stefan Halder, 总经理 / General Manager