

## 星形把手 · DIN 6335 轻合金

EH 24630.

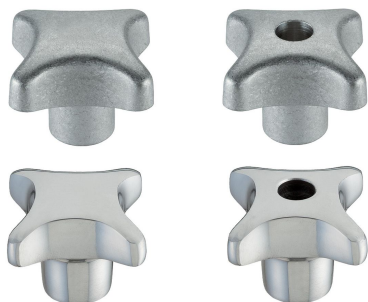

### 产品描述

These palm grips are manufactured according to DIN 6335.

### 材质

#### 把手

- 轻合金 (铝), 未抛光或抛光

### 图面

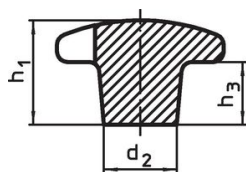

图片 1

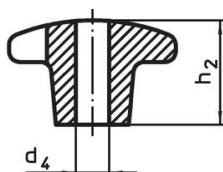

图片 2

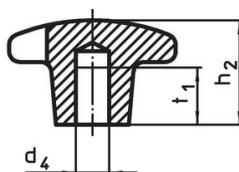

图片 3

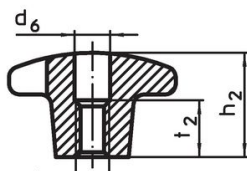
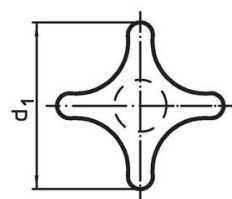

图片 4

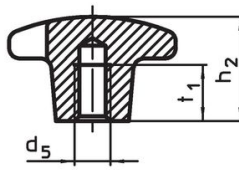

图片 5

### 订单信息

d <sub>1</sub>	d <sub>2</sub>	d <sub>4</sub> H7	d <sub>5</sub>	尺寸						[g]	品号	
				d <sub>6</sub>	h <sub>1</sub>	h <sub>2</sub>	h <sub>3</sub>	t <sub>1</sub>	t <sub>2</sub>			
[mm]												
未加工, 型式 A – 相片 1, 未抛光												
40	14	-	-	-	26	-	14	-	-	27	24630.0040	
50	18	-	-	-	34	-	20	-	-	51	24630.0050	
63	20	-	-	-	42	-	25	-	-	95	24630.0063	
80	25	-	-	-	52	-	30	-	-	161	24630.0080	
有平滑盲孔, 型式 C – 相片 3, 未抛光												
40	14	8	-	-	-	25	-	15	-	23	24630.0240	
50	18	10	-	-	-	32	-	18	-	42	24630.0250	
63	20	12	-	-	-	40	-	22	-	73	24630.0263	
80	25	16	-	-	-	50	-	28	-	138	24630.0280	
有母牙螺纹, 钻孔, 型式 D – 相片 4, 未抛光												
40	14	-	M 8	8,4	-	25	-	-	13	23	24630.0340	
50	18	-	M10	10,5	-	32	-	-	16	44	24630.0350	
63	20	-	M12	13,0	-	40	-	-	20	70	24630.0363	
80	25	-	M16	17,0	-	50	-	-	20	129	24630.0380	
有盲孔, 母牙, 型式 E – 相片 5, 未抛光												
40	14	-	M 8	-	-	25	-	15	-	24	24630.0440	
50	18	-	M10	-	-	32	-	18	-	46	24630.0450	
63	20	-	M12	-	-	40	-	22	-	74	24630.0463	
80	25	-	M16	-	-	50	-	28	-	142	24630.0480	

d <sub>1</sub>	d <sub>2</sub>	d <sub>4</sub> H7	d <sub>5</sub>	尺寸						[g]	品号
				d <sub>6</sub>	h <sub>1</sub>	h <sub>2</sub>	h <sub>3</sub>	t <sub>1</sub>	t <sub>2</sub>		
[mm]											
<b>有平滑盲孔，型式 C – 相片 3, 已抛光</b>											
40	14	8	–	–	–	25	–	15	–	23	<a href="#">24630.0640</a>
50	18	10	–	–	–	32	–	18	–	42	<a href="#">24630.0650</a>
63	20	12	–	–	–	40	–	22	–	73	<a href="#">24630.0663</a>
80	25	16	–	–	–	50	–	28	–	138	<a href="#">24630.0680</a>
<b>有母牙螺纹，钻孔，型式 D – 相片 4, 已抛光</b>											
40	14	–	M 8	8,4	–	25	–	–	13	23	<a href="#">24630.0740</a>
50	18	–	M10	10,5	–	32	–	–	16	44	<a href="#">24630.0750</a>
63	20	–	M12	13,0	–	40	–	–	20	70	<a href="#">24630.0763</a>
80	25	–	M16	17,0	–	50	–	–	20	129	<a href="#">24630.0780</a>
<b>有盲孔，母牙，型式 E – 相片 5, 已抛光</b>											
40	14	–	M 8	–	–	25	–	15	–	24	<a href="#">24630.0840</a>
50	18	–	M10	–	–	32	–	18	–	46	<a href="#">24630.0850</a>
63	20	–	M12	–	–	40	–	22	–	74	<a href="#">24630.0863</a>
80	25	–	M16	–	–	50	–	28	–	142	<a href="#">24630.0880</a>

### 应用范例

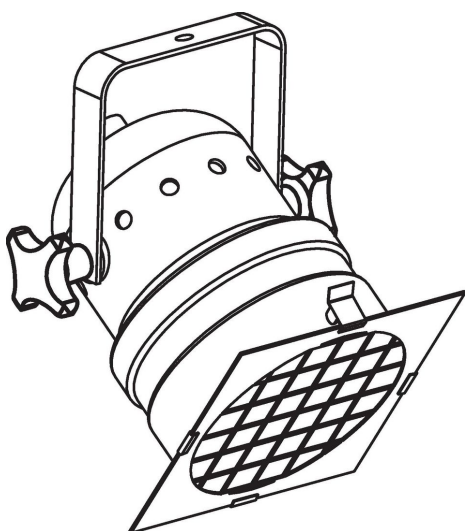

### 遵守

For detailed compliance information please select the desired article number.