

球形旋钮 · 金属类型，接近于 DIN 319

EH 24561.



产品描述

材质

- 钢、打磨、光亮
- 不锈钢 1.4305，钝化喷砂
- 铝、磨光的

更多信息

注意事项

供应 DIN 319 Form C 金属型式。

图面

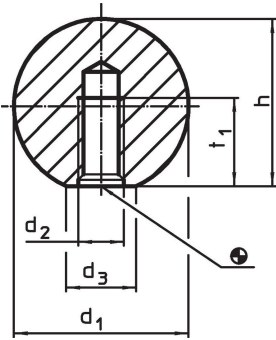

订单信息

d ₁	d ₂	尺寸 d ₃ ~ [mm]	h ~	t ₁ min	 [g]	品号
钢						
16	M 4	8	15,0	7,0	16	24561.0016
20	M 5	12	18,0	9,0	26	24561.0020
25	M 6	15	22,5	11,0	58	24561.0025
32	M 8	18	29,0	14,5	116	24561.0032
40	M10	22	37,0	18,0	241	24561.0040
50	M12	27	46,0	21,0	475	24561.0050
不锈钢						
16	M 4	8	15,0	7,0	16	24561.0216
20	M 5	12	18,0	9,0	26	24561.0220
25	M 6	15	22,5	11,0	58	24561.0225
32	M 8	18	29,0	14,5	116	24561.0232
40	M10	22	37,0	18,0	241	24561.0240
铝						
16	M 4	8	15,0	7,0	16	24561.0116
20	M 5	12	18,0	9,0	26	24561.0120
25	M 6	15	22,5	11,0	58	24561.0125
32	M 8	18	29,0	14,5	116	24561.0132
40	M10	22	37,0	18,0	241	24561.0140
50	M12	27	46,0	21,0	475	24561.0150

应用范例

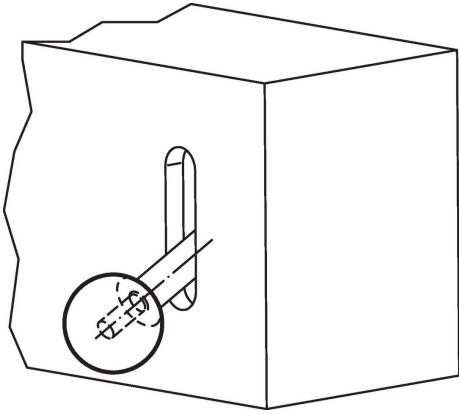

遵守

For detailed compliance information please select the desired article number.