

定位柱 · 有头，带有球端与内六角  
EH 22030.



产品描述

适用于定位、供压或顶举。  
由头部精确的深啮

材质

本体  
• 切削钢， 染黑  
• 不锈钢 1.4305

珠子

• 轴承钢， 硬化  
• 不锈钢， 硬化

弹簧

• 不锈钢

组装

用于 M4 / M5 参照尺寸  $l_3$ 。

特性

标准弹簧荷重: 无标示  
强化弹簧荷重: 以两条线标示

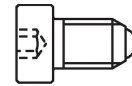

Standard spring load

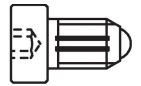

Heavy spring load

更多信息

注意事项

特殊的样式欢迎洽询。  
定位柱经过特别测试，以得知其弹簧的范围和作用。

参考

需求的螺纹锁，请参阅附录 - 技术数据 - 索引阻力的计算，细节请参考本章节的起始。

更多产品

- Locators, with bore hole, for spring plungers
- Locators, smooth, for spring plungers

图面

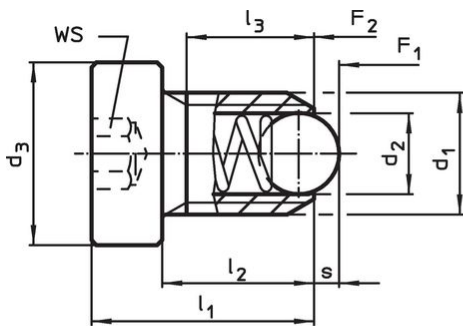

Size M4+M5

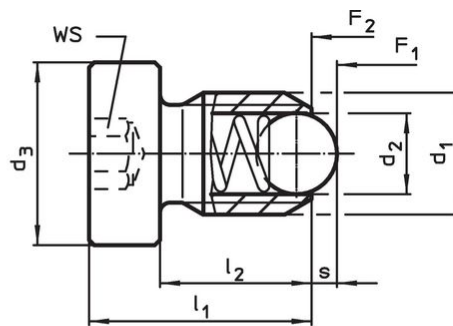

Size M6-M12

订单信息

尺寸						WS	行程 s	弹簧荷重 <sup>1)</sup>		max. [°C]	[g]	品号
d <sub>1</sub>	d <sub>2</sub>	d <sub>3</sub>	l <sub>1</sub>	l <sub>2</sub>	l <sub>3</sub> min			F <sub>1</sub> ~	F <sub>2</sub> ~			
[mm]						[mm]	[mm]	[N]				
切削钢， 标准弹簧荷重												
M 4	2,5	6	12	9,0	7,5	2,0	0,8	8,0	14,0	250	1,0	22030.0930
M 5	3,0	8	14	10,0	8,2	2,5	0,9	8,0	14,0	250	2,3	22030.0931
M 6	3,5	10	15	10,0	-	3,0	1,0	11,0	18,0	250	3,9	22030.0932
M 8	4,5	13	18	12,5	-	4,0	1,5	18,0	31,0	250	7,8	22030.0933
M10	6,0	16	23	17,0	-	5,0	2,0	24,0	45,0	250	14,0	22030.0934
M12	8,0	18	26	19,0	-	6,0	2,5	26,0	49,0	250	21,0	22030.0935

<sup>1)</sup> 统计平均值

d <sub>1</sub>	d <sub>2</sub>	尺寸				WS [mm]	行程 s [mm]	弹簧荷重 <sup>1)</sup>		max. [°C]	[g]	品号
		d <sub>3</sub>	l <sub>1</sub>	l <sub>2</sub>	l <sub>3</sub> min			F <sub>1</sub> ~ [N]	F <sub>2</sub> ~ [N]			
<b>切削钢，增强 弹簧荷重</b>												
M 4	2,5	6	12	9,0	7,5	2,0	0,8	12,0	18,0	250	1,1	<a href="#">22030.1040</a>
M 5	3,0	8	14	10,0	8,2	2,5	0,9	15,0	22,0	250	2,3	<a href="#">22030.1050</a>
M 6	3,5	10	15	10,0	-	3,0	1,0	19,3	26,6	250	3,9	<a href="#">22030.1060</a>
M 8	4,5	13	18	12,5	-	4,0	1,5	36,0	60,5	250	7,8	<a href="#">22030.1080</a>
M10	6,0	16	23	17,0	-	5,0	2,0	57,0	103,5	250	14,0	<a href="#">22030.1100</a>
M12	8,0	18	26	19,0	-	6,0	2,5	61,0	110,0	250	21,0	<a href="#">22030.1120</a>
<b>不锈钢，标准弹簧荷重</b>												
M 4	2,5	6	12	9,0	7,5	2,0	0,8	8,0	14,0	250	1,1	<a href="#">22030.0940</a>
M 5	3,0	8	14	10,0	8,2	2,5	0,9	8,0	14,0	250	2,3	<a href="#">22030.0941</a>
M 6	3,5	10	15	10,0	-	3,0	1,0	11,0	18,0	250	3,9	<a href="#">22030.0942</a>
M 8	4,5	13	18	12,5	-	4,0	1,5	18,0	31,0	250	7,8	<a href="#">22030.0943</a>
M10	6,0	16	23	17,0	-	5,0	2,0	24,0	45,0	250	14,0	<a href="#">22030.0944</a>
M12	8,0	18	26	19,0	-	6,0	2,5	26,0	49,0	250	21,0	<a href="#">22030.0945</a>
<b>不锈钢，增加 弹簧荷重</b>												
M 4	2,5	6	12	9,0	7,5	2,0	0,8	12,0	18,0	250	1,1	<a href="#">22030.2040</a>
M 5	3,0	8	14	10,0	8,2	2,5	0,9	15,0	22,0	250	2,3	<a href="#">22030.2050</a>
M 6	3,5	10	15	10,0	-	3,0	1,0	19,3	26,6	250	3,9	<a href="#">22030.2060</a>
M 8	4,5	13	18	12,5	-	4,0	1,5	36,0	60,5	250	7,9	<a href="#">22030.2080</a>
M10	6,0	16	23	17,0	-	5,0	2,0	57,0	103,5	250	14,0	<a href="#">22030.2100</a>
M12	8,0	18	26	19,0	-	6,0	2,5	61,0	110,0	250	22,0	<a href="#">22030.2120</a>

<sup>1)</sup> 统计平均值

#### 应用范例

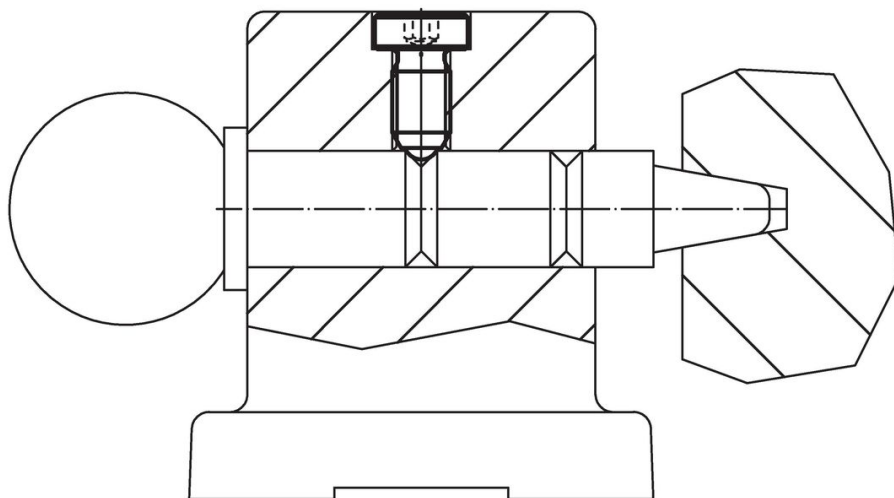

#### 遵守

For detailed compliance information please select the desired article number.