

星形把手 · DIN 6335 轻合金

24630.0380



产品描述

These palm grips are manufactured according to DIN 6335.

材质

把手

- 轻合金 (铝), 未抛光或抛光

图面

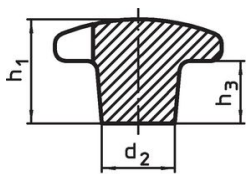

图片 1

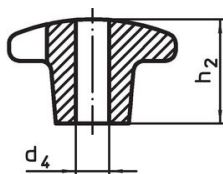

图片 2

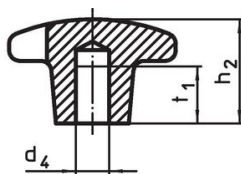

图片 3

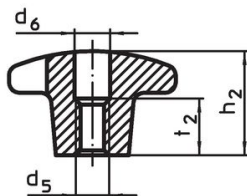
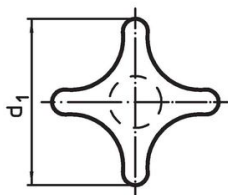

图片 4

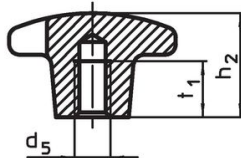

图片 5

订单信息

| d ₁ | d ₂ | d ₅ | 尺寸 [mm] | d ₆ | h ₂ | t ₂ |  [g] | 品号 |
|----------------|----------------|----------------|------------|----------------|----------------|----------------|--|------------|
| 80 | 25 | M16 | | 17 | 50 | 20 | 129 | 24630.0380 |

应用范例

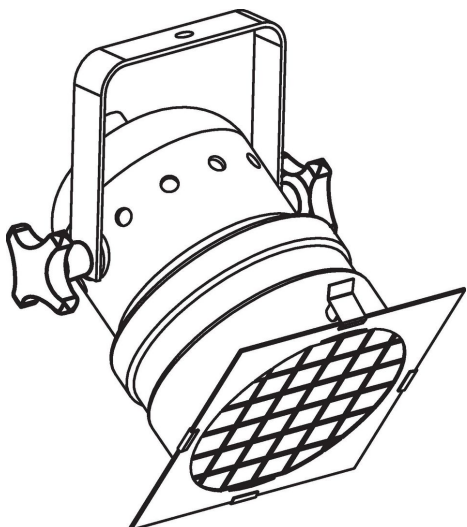

遵守

符合 RoHS

含铅 - 符合例外 6a / 6b / 6c

含有 >0.1% w/w 的 SVHC 物质

含铅 - SVHC [REACH] 清单截至 2024 年 6 月 27 日

包含 65 号提案的物质



铅暴露会导致癌症和生殖伤害

<https://www.P65Warnings.ca.gov/>

不含冲突矿物

„本产品不含来自刚果民主共和国或邻近国家的任何被指定为“冲突矿物”的物质，例如钽、锡、金或钨。